

# 2402 Series- Gematic 8 Key Change Cam Locks

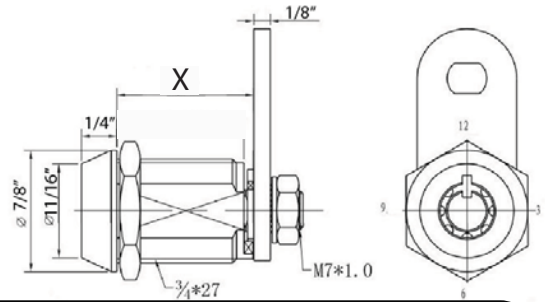

X=  
2402BS- 5/8"  
2402BM- 7/8"  
2402BL- 1-1/8"

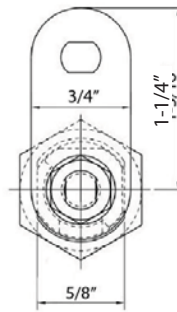

- 2402 has red indicator which key code is being used, 2421 has no indicator
- 7 pin tubular keyway
- Available in 5/8", 7/8" and 1-1/8" lengths
- 1-1/4" straight cam included
- Zinc alloy housing and barrel. Brass spindel optional
- Other optional cams available to the right

Straight			Offset		
Sku	Length		Sku	Length	Off
1 130049	5/8"	11	30597D	2-1/4"	1/4"
2 130050D	3/4"	12	30596D	2"	1/2"
3 130009D	1-1/8"	13	30002D	1-5/8"	3/8"
4 130047D	1-1/4"	14	30026D	1-1/2"	1/4"
5 130023D	1-1/2"	15	30025D	1-1/2"	1/8"
6 130058	1-5/8"	16	30027D	1-1/2"	1/2"
7 130056D	2"	17	30594D	1-1/4"	1/4"
		18	30593D	1-1/4"	1/8"
		19	30595D	1-1/4"	1/2"

## Gematic 8 Key Change Locks

These programmable gematic locks allow the user to change keying of their locks, while already installed, to as many as 8 different key codes. Change to any of 8 of the key codes at any time. Offers low security, easy to do, key changes at any time with the Code Change Key.

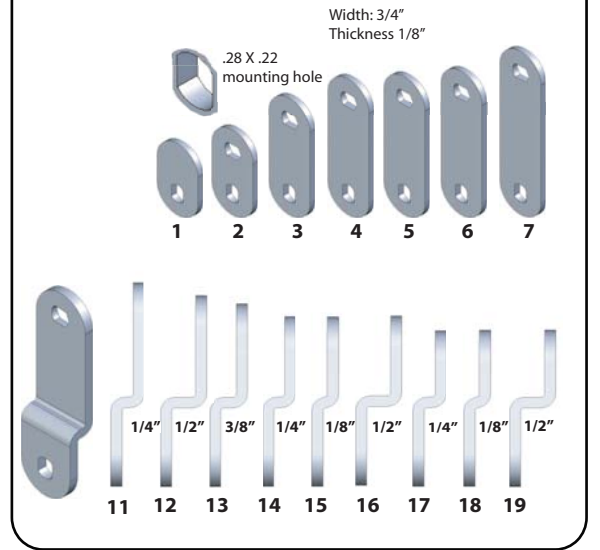

# 2522 Series- Gematic 8 Key Change Cylinder Locks



MM

- Key retaining
- Cylinder diameter 3/4"
- 8 key changes and one code change key included
- Zinc alloy housing and barrel
- Available keyed alike

